

## BVEIL-KT

solid security escutcheons with cylinder protection SKG\*\*\*

### Product information

Code: Nour\_1502SR06IMXX0

Finish: PVD satin gold

UNIT: Set

Collection: NOUR

Designer: Edward van Vliet

EAN code: 8718009312001

### NOUR by Edward van Vliet

The NOUR series is a total concept collection consisting of door, window, and furniture fittings.

### Finishes

- satin stainless steel
- satin black
- bronze
- satin black
- polished stainless steel
- PVD satin gold
- satin stainless steel
- satin stainless steel
- PVD satin stainless steel
- polished stainless steel
- satin black
- PVD gunmetal
- PVD satin gold
- PVD polished copper

# BVEIL-KT

sold security escutcheons  
with cylinder protection cover  
stainless steel

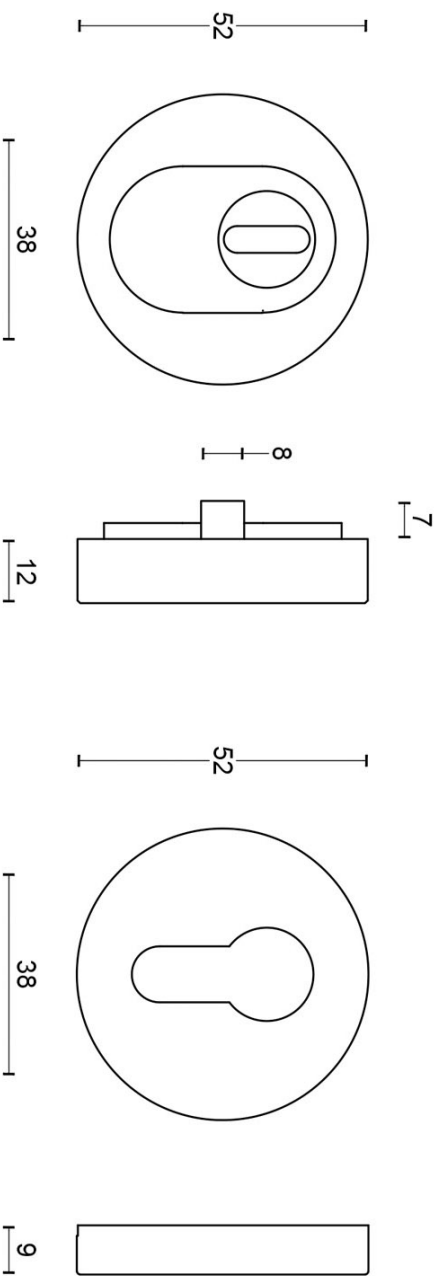
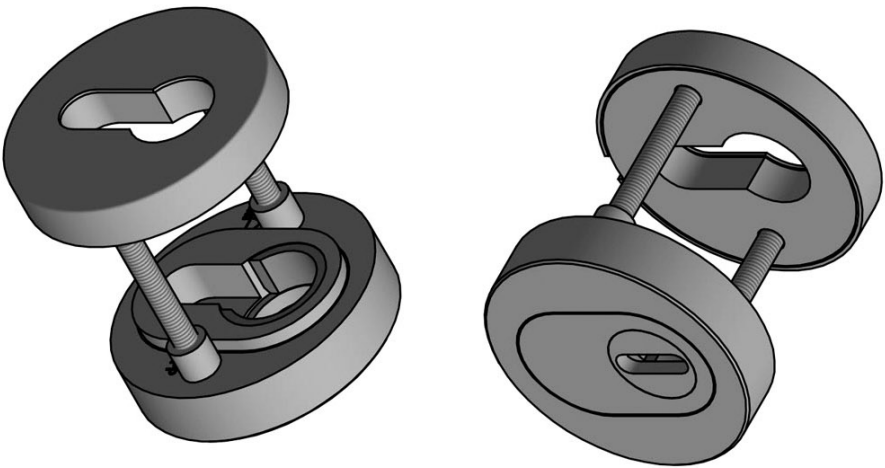

<b>FORMANI®</b>		Part number:
Doc no.:	1502SR06 BVEIL-KT V01.dwg	Description:
Drawn by:	Christian Brimbois	<b>BVEIL-KT</b>
Creation date:	26-9-2017	Format:
FORMANI HOLLAND B.V. - EUROPALAAN 12 6199 AB MAASTRICHT-AIRPORT NL T +31 (0)43 308 90 00 INFO@FORMANI.COM FORMANI.COM		<b>A3</b>

# NOUR

by Edward van Vliet

**Our NOUR series by Edward van Vliet combines an international appeal and aesthetic with excellent ergonomic features. The door handle's design perfectly fits into the shape of your hand thanks to the streamlined silhouettes. In addition to its excellent ergonomic factor, this special design has drawn on many aesthetic influences from the Far and Middle East. The NOUR series concerns a comprehensive total concept collection including door, window, and furniture fittings and received a German Design Award thanks to its range of unique characteristics, one of which being its inherent flexibility. The range has a modular structure, so that the grips can be replaced and other colours substituted. This allows for a variety of stunning combinations of polished stainless steel, PVD matt gold, matt black, and matt white, completed with a signature or logo specially designed for FORMANI.**

# NOUR

by Edward van Vliet



FORMANI®

A black and white portrait of Edward van Vliet, a man with short, dark hair and a light beard, wearing a dark V-neck shirt and a thin chain necklace. He is looking directly at the camera with a neutral expression.

# Edward van Vliet

Winterswijk, 1965

Design philosophy: Creating worlds

**Layers creating depth and dimension are key at Studio Edward van Vliet. His design is based on creating an experience by going beyond aesthetic boundaries, ensuring a keen eye for detail, and incorporating various cultural influences. His collaboration with FORMANI resulted in the creation of the NOUR hardware series, from the design of which is inspired by influences from the Far East. Our door fittings are the hidden gems of these architectural layers. They are treasures that enrich and personalize each space.'**

# Brand story

**FORMANI has evolved considerably over the last few decades – from a Dutch family business to an internationally renowned designer brand, from door handles to total design concepts, from product development to collaborations with world-class designers. It was an evolution driven by pure ambition and courage. Our motto, ‘Obsessed with details’, epitomizes everything we do, from product to process, from strategy to service. Because it is these details that make the difference between good and perfect. At FORMANI, good is the enemy of great.**

---

Formani Holland b.v.  
Europalaan 12  
6199 AB  
Maastricht-Airport

T: +31(0)43 308 9000  
E: [info@formani.com](mailto:info@formani.com)

Chamber of Commerce:  
146 27 479

**FORMANI®**